



Safety Reel

Guide

19 911 31XX PUR Hose Reels (Air)
 19 911 32XX PUR Hose Reels (Water)
 19 911 41XX EPDM rubber Hose Reels (Air/Water)
 19 911 61XX Hoseless Reels



Edition A - 2017.11.03

CEJN AB
 Hasslumsvägen 33
 S-541 25 Skövde
 Sweden
www.cejn.com



User instructions:
www.cejn.com/safetyreel

EC Declaration of Conformity – We declare that the products identified below:
 Hose Reel Type 19 911 3XXX, 19 911 4XXX and 19 911 6XXX conform to:
 2006/42/EG (EN ISO 12100:2010)

1. Safety



WARNING!

The products are intended for use by knowledgeable persons having the technical skill necessary to evaluate their suitability for specific applications. Read all safety instructions carefully before attempting to install, operate, or maintain this product. Only qualified personnel should undertake the installation, commissioning and maintenance of this product. Before carrying out maintenance or repair work, always disconnect the hose reel from the air source. If the reel must be disassembled, release spring tension before further dismantling.



2. Installation

For more detailed information regarding installing and operating of the reel, see our instructions at www.cejn.com/safetyreel

2.1 Assembly

1

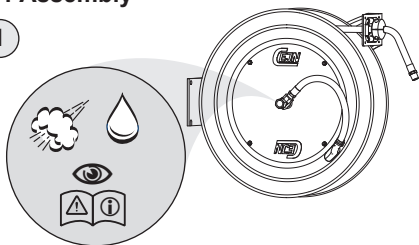

2

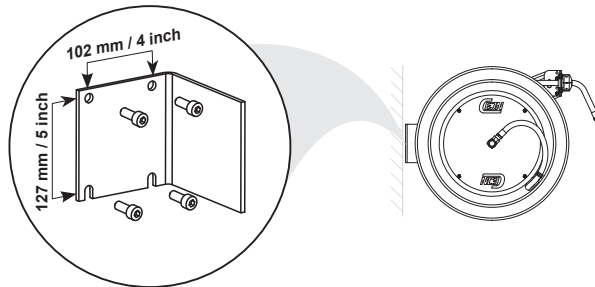

3

Mounting-positions

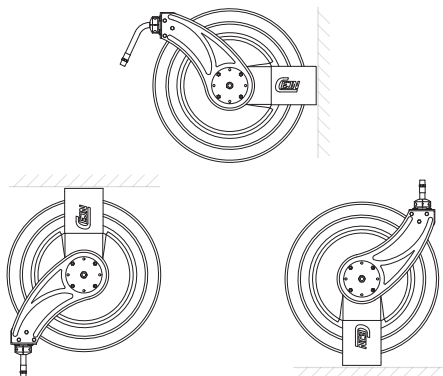

4

Arm-positions

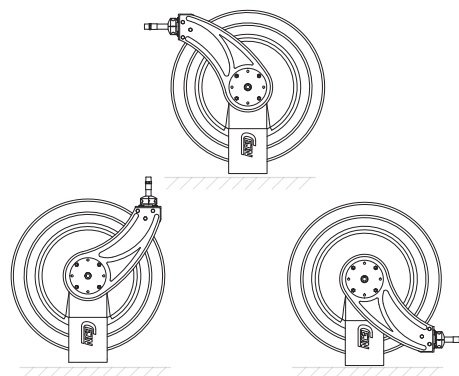

2.2 Hose length

The stop ball is allowed to be moved inwards.
 The spring force can be adjusted.
 See instructions for further information at
www.cejn.com/safetyreel

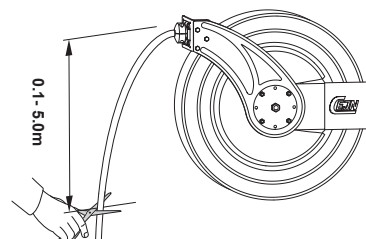
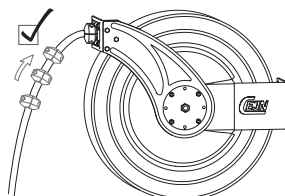

2.3 Connecting the hose reel

Connect the reel to the air/water source at the correct working pressure as follows:

	199113150/-3152/-3153/-3155/-3157/-3158	199113141/-3146/-3241/-3246	199113162/-3167	199113171/-3176	199113250/-3255/-3253/-3258	199113271/-3276
Application	Compressed air	Compressed air / Water	Compressed air	Compressed air	Water	Water
Hose length	15 m, 23 m, 30 m	18 m	23 m	15 m	15 m , 30 m	15 m
Internal diameter of hose	Ø 13 mm	Ø 9,5 mm	Ø 16 mm	Ø 19 mm	Ø 13 mm	Ø 19 mm
Connection	1/2"	3/8"	3/4"	3/4"	1/2"	3/4"
Temperature range	-20°C - +60°C	-20°C - +60°C (air) / 5°C- +60°C (water)	-20°C - +60°C	-20°C - +60°C	5°C - +60°C	5°C - +60°C
Max working pressure	10 bar	10 bar	10 bar	10 bar	10 bar	10 bar

	199114152/-4157/-4153/-4158	199114171/-4176	199116141/-6146	199116150/-6155/-6151/-6156/-6152/-6157/-6153/-6158	199116170/-6175/-6171/-6176	
Application	Compressed air / Water	Compressed air / Water	Compressed air / Water	Compressed air / Water	Compressed air / Water	
Hose length	23 m, 30 m	15 m	18 m	7 m, 15 m, 23m, 30 m	7 m, 15 m	
Internal diameter of hose	Ø 1/2"	Ø 3/4"	Hoseless	Hoseless	Hoseless	
Connection	1/2"	3/4"	3/8"	1/2"	3/4"	
Temperature range	-20°C - +60°C (air) / 5°C- +60°C (water)	-20°C - +60°C (air) / 5°C- +60°C (water)	-28°C - +100°C	-28°C - +100°C	-28°C - +100°C	
Max working pressure	20 bar	20 bar	20 bar	20 bar	20 bar	

3. Operation

3.1 Pulling out the hose

- (1) Pull out the hose to the required length.
- (2) To lock the hose, listening for the latch to engage with a "click" while slowly pulling out the hose a small distance.

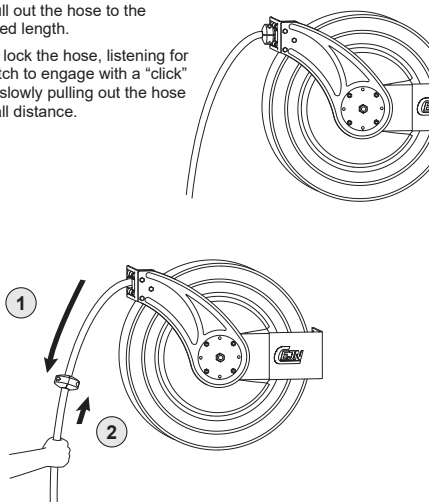

3.2 Retracting the hose

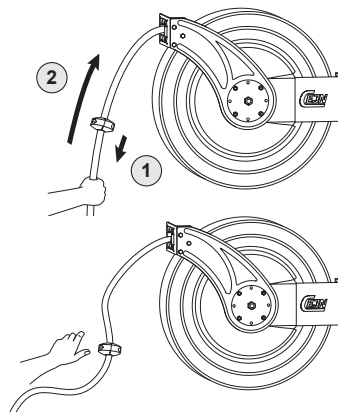

To unlock the hose when you have finished using it, (1) simply pull it out a small distance and listen for the latch to stop "clicking".
(2) Then let the hose slowly retract back into the housing.

Slow retraction
The Safety Reel is equipped with a **Safety Clutch** controlled retraction system for up to 80% slower retraction- prevent injury and easier on equipment.

3.3 The hose cannot be fully retracted

If the hose gets jammed when retracted, simply pull out the hose to its full length and let it retract freely without assistance. If you experience further problems or other malfunctions, contact your local distributor for guidance. See instructions at www.cejn.com/safetyreel for more guidance.

4. Maintenance



- Carry out regular checks that there are no problems with the hose and external parts. For detailed guidance of how to replace the hose, please see instructions at www.cejn.com/safetyreel
- Any damage or defects must be repaired immediately.
- Repairs and maintenance must be carried out by a qualified technician only.
- Only original spare parts must be used!

5. Disposal/Recycling



IMPORTANT!
Help us to take care of the environment. When disposing of the hose reel, please do so in accordance with local environmental regulations.

6. Warranty

CEJN AB provides a two (2) year warranty from the date of manufacture. Contact your retailer concerning warranty enquiries.

7. Spare parts

For safety reasons, only original spare parts must be used. For a complete overview of spare parts, see www.cejn.com/safetyreel

Marcus Allerbjer
 Marcus Allerbjer
 CEJN AB